



Illustrated perspective of the facade

Launch



CASA NACIONAL eztec

PSV %Eztec: R\$ 396.7 million

Standard: Middle-high

%Eztec: 100%

Location: Brooklin

Units: 188

Private Area: 24,703 s.q.m

Eztec presents its new development, Casa Nacional. Located on Rua Diogo de Quadros, only 400 meters from Shopping Morumbi, the project blends urban dynamism with a strong presence of nature. The landscaping is designed by Burle Marx Escritório de Paisagismo, highlighting a rich, organic, and authentic Brazilian identity.

Among its key features, the rooftop pool stands out, offering a unique leisure experience with a privileged view of the city.

With units ranging from 114 to 136 sqm (2 and 3-bedroom suites), Casa Nacional is aimed at the middle-high income segment, in a location that for many will become the new heart of São Paulo. A private haven that celebrates a lifestyle that is light, sophisticated, and deeply Brazilian.

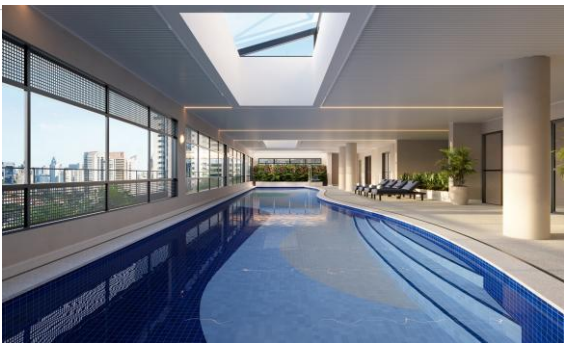

Illustrated perspective of the indoor Swimming pool



Illustrated perspective of the Sports Court

With **47 years of operations**, EZTEC is one of the most profitable publicly-traded companies in Brazil's real estate development and building industry. Based on its fully integrated business model, EZTEC has already **launched 197 projects**, totaling more than **5.8 million square meters of built area and area under construction, and 48,006 units**.

EZTEC S.A. is listed on the **Novo Mercado** special corporate governance segment of the São Paulo Stock Exchange (BM&FBOVESPA) under the ticker **EZTC3**

EZTC
B3 LISTED NM

IBRA B3 IBRX100 B3 ICON B3 IGC B3 IDIV B3
IGCT B3 IGC-NM B3 IMOB B3 INDX B3 ITAG B3 SMLL B3

For more additional information, please contact:

Investor Relations- Eztec S.A.
(11) 5056-8313 | ri@eztec.com.br | www.eztec.com.br/ri

This notice contains forward-looking statements regarding the business outlook, estimates of operational and financial results, and the growth prospects of Eztec. These are merely projections and, as such, are based solely on the Company's management expectations regarding the future of the business and its continued access to capital to finance its business plan. Such forward-Looking statements depend largely on changes in market conditions, government regulations, competitive pressures, industry performance, and the Brazilian economy, among other factors, in addition to the risks presented in the disclosure documents filed by the Company and are therefore subject to change without notice.

You are receiving this email because you are registered to receive Investor Relations information from Eztec. To ensure that you receive this newsletter in the future, please add noreply@mziq.com to your approved senders list.

No longer wish to receive this type of email? [Click here](#) to unsubscribe.